

Plotted: Mar 27, 2023 - 9:19am dyu Layout: 08.00
 M:\2021\2100135 Skagway Ore Peninsula Multi-Use Dock\Drawings\Current\2100135_08.00 Overall_Site_Plan.dwg

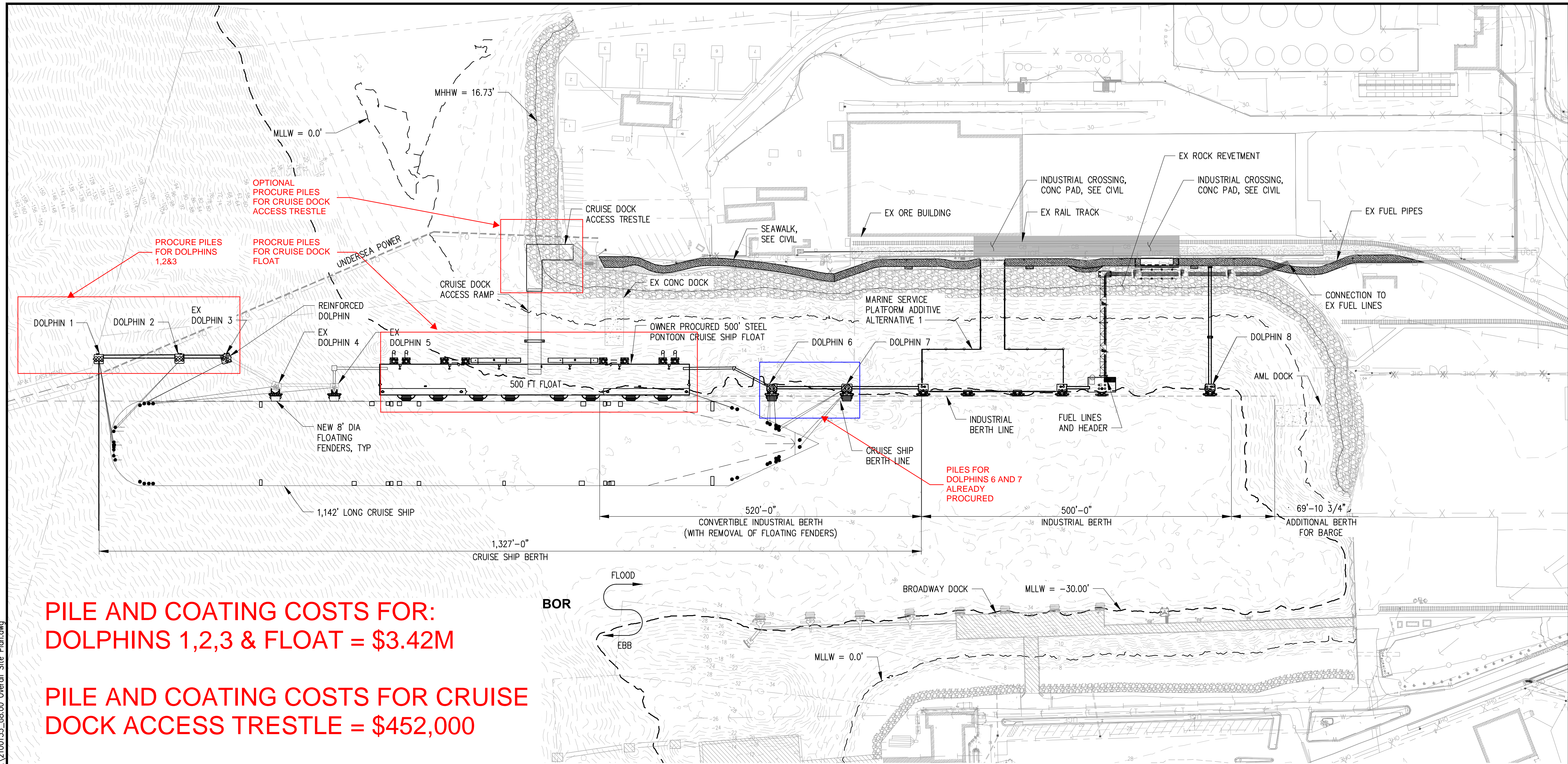

**PILE AND COATING COSTS FOR:
 DOLPHINS 1,2,3 & FLOAT = \$3.42M**

**PILE AND COATING COSTS FOR CRUISE
 DOCK ACCESS TRESTLE = \$452,000**

**TOTAL = \$3.9M
 (includes 10% contingency)**

OVERALL SITE PLAN
 SCALE: 1" = 80'

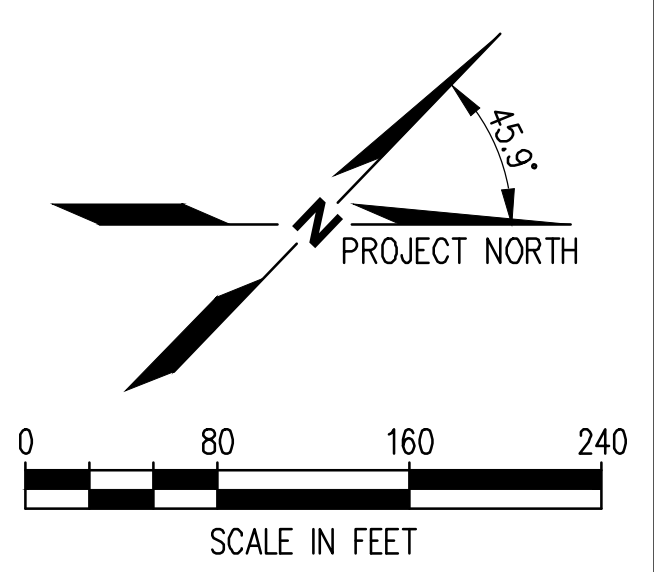

1601 5th Avenue, Suite 1300
 Seattle, Washington 98101
 (206) 382-0600 Fax (206) 382-0500

NO.	DATE	BY	REVISION



ORE PENINSULA REDEVELOPMENT
 SKAGWAY, ALASKA

OVERALL SITE PLAN

DRAWN: JH	PROJECT NO.: 2100135
DESIGN: ED	SCALE: AS SHOWN
CHECKED: RR	DATE: 03/24/2023
DRAWING NO.	G8.00
SHEET NO.	OF

90% DESIGN - NOT FOR CONSTRUCTION