

Scope B - With Deep Water Dolphins	
Construction - Including the two deep water dolphins	\$ 41,196,876
Project Management and permit compliance	\$ 5,288,490
Total	\$ 46,485,366
Remaining Revenue Bond	\$ 45,000,000

Scope A - Minus Deep Water Dolphins	
Construction - Minus the two deep water Dolphins	\$ 37,026,401
Project Management and permit compliance	\$ 5,288,490
Total	\$ 42,314,891
Remaining Revenue Bond	\$ 45,000,000

NOTES

- PHASE 1 INCLUDES:
 - CRUISE SHIP FLOAT INSTALLATION
 - CRUISE SHIP ACCESS TRESTLE
 - UPGRADES TO DOLPHINS 3, 4, AND 5
 - INSTALL NEW DOLPHINS 6 AND 7
 - DEMOLISH ORE LOADER
 - CONSTRUCT TEMP FUEL HEADER AT BROADWAY DOCK

LEGEND

- ITEMS TO BE CONSTRUCTED IN PHASE 1
- ORE LOADER TO BE DEMOLISHED IN PHASE 1
- ITEMS TO BE CONSTRUCTED IN FUTURE PHASE
- ORE LOADER SUPPORT PLATFORM TO BE DEMOLISHED IN FUTURE PHASE
- YUKON - MARINE SERVICES PLATFORM (MSP), AND UPLANDS TO BE CONSTRUCTED IN FUTURE PHASE
- EXITING ORE TERMINAL BUILDING CONVEYOR TO BE DEMOLISHED FOR MSP OPERATIONS

OVERALL SITE PLAN

SCALE: 1" = 80'

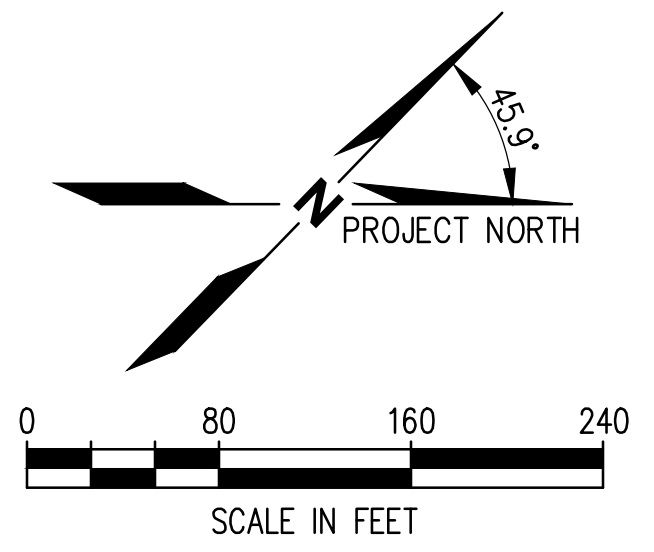

Plotted: Jul 11, 2023 - 1:23pm dju Layout: EXHIBIT 1
 M:\2021\2100135 Skagway Ore Peninsula Multi-use Dock\Drawings\Exhibit\2023-07-11 Exhibit\2100135_08.00 Overall Site Plan.dwg

1601 5th Avenue, Suite 1300
 Seattle, Washington 98101
 (206) 382-0600 Fax (206) 382-0500

NO.	DATE	BY	REVISION



ORE PENINSULA REDEVELOPMENT
 SKAGWAY, ALASKA

OVERALL SITE PLAN
PHASING PLAN

DRAWN: DYU	PROJECT NO.: 2100135
DESIGN: ED	SCALE: AS SHOWN
CHECKED: RR	DATE: 07/11/2023
DRAWING NO.	EX-1
SHEET NO.	01 OF 01

EXHIBIT